

1/2" NPT LEADWIRE OUTLET FOR EXTERNAL CONNECTION TO MOTOR. BRAKE CAN BE ROTATED TO (4) 90° POSITIONS.

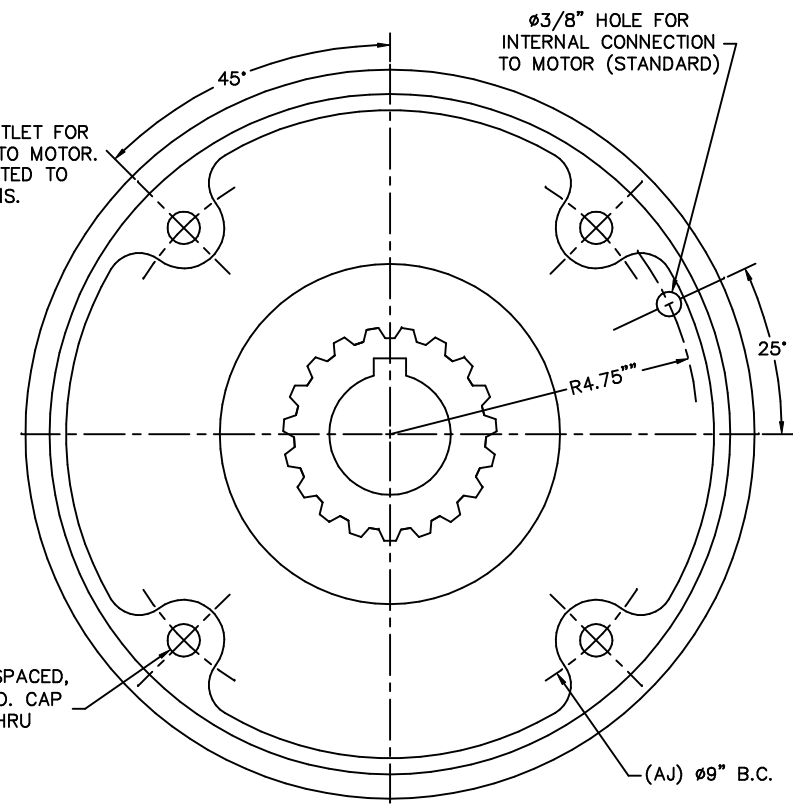

(4) HOLES, EQUALLY SPACED, FOR 1/2 DIA. SOC. HD. CAP SCREW: LENGTH THRU BRACKET = 1"

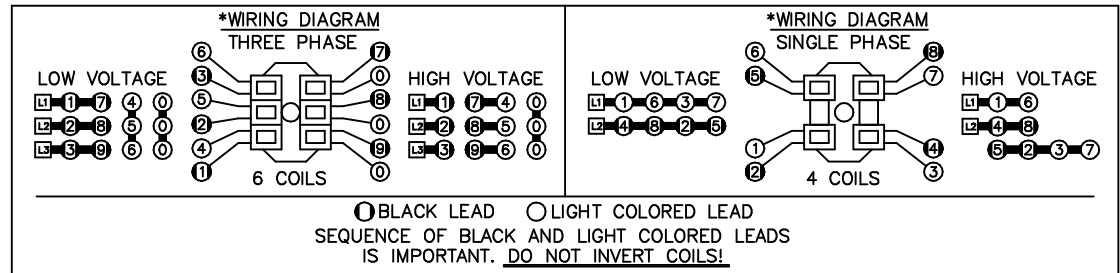

MODEL NUMBER	TORQUE LB.FT.	No. OF ROTATING FRICTION DISC	MAX. RPM	THERMAL CAPACITY HPS/MIN.	INERTIA WK ² LB.FT ²	DIMENSIONS							BRACKET MATERIAL	COVER MATERIAL
						"C"	"D" ±.005 MAX. ORIGINAL SETTING	"H"	"N" ±1/32	"X"	"AC"			
6-81025-57	25	1	2400	15	.084	6.25	.065	.040	1.28	1.75	1.00	1.72	CAST IRON	STAMP STEEL
6-81035-57	35	1	2400	15	.084	6.25	.065	.040	1.28	1.75	1.00	1.72	CAST IRON	STAMP STEEL
6-82050-57	50	2	2400	17	.158	6.87	.065	.040	1.28	2.25	1.50	2.34	CAST IRON	STAMP STEEL
6-82070-57	70	2	2400	17	.158	6.87	.065	.040	1.28	2.25	1.50	2.34	CAST IRON	STAMP STEEL
6-83075-57	75	3	2400	19	.233	7.50	.070	.045	1.28	2.75	2.00	2.97	CAST IRON	STAMP STEEL
6-83105-57	105	3	2400	19	.233	7.50	.070	.045	1.28	2.75	2.00	2.97	CAST IRON	STAMP STEEL
6-84125-57	125	4	2400	21	.307	8.12	.080	.055	1.37	3.25	2.50	3.59	CAST IRON	STAMP STEEL
6-85175-57	175	5	2400	21	.384	8.75	.080	.055	1.28	3.87	3.12	4.22	CAST IRON	STAMP STEEL

*SEE BULLETIN BK4803 FOR OPERATING, INSTALLATION AND PARTS INSTRUCTIONS

SYMBOL KEY:
 "C" = ENCLOSURE LENGTH
 "D" = MAGNET AIR GAP
 "H" = INSTALLED SPRING LENGTH
 "N" = HUB LOCATION DIMENSION
 "X" = OVERALL HUB LENGTH
 "AC" = EXTERNAL WIRING OUTLET DIMENSION

THIS MATERIAL IS PROPERTY OF DISCO COMPANY. NO RIGHTS ARE GRANTED TO USE THIS MATERIAL FOR ANY PURPOSE OTHER THAN (1) PRODUCT EVALUATION OR MAINTENANCE OR (2) THE FURNISHING OF SERVICES AND SUPPLIES TO THE DISCO COMPANY.

OUTLINE DRAWING, 80 SERIES, NEMA 2
 DEEP DRAWN COVER: 2 POST (S8057)

TOLERANCE UNLESS OTHERWISE NOTED .005 & .010 FRACTIONS & .001 .005 & .010 UNLESS NOTED	
DATE: 12/08/99 DESIGNED BY: FULL DRAWING NO.: L080223 SHEET NO.: 1 OF 1	